

TURN ON SYSTEM:

- Projector - **PRESS the "ON" button.**
- *ON BUTTON will turn RED*
- *SCREEN WILL TURN On*
- *ENSURE PC button is RED to be on PC.*
- Podium PC will already be on.

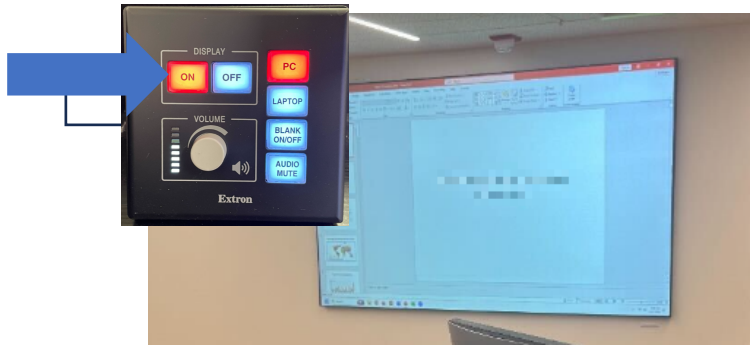

LAPTOP USE:

- Use HDMI cable
- Use HDMI cable+USB-C Adapter (as needed)
- PRESS LAPTOP on panel.
- LAPTOP button will turn RED

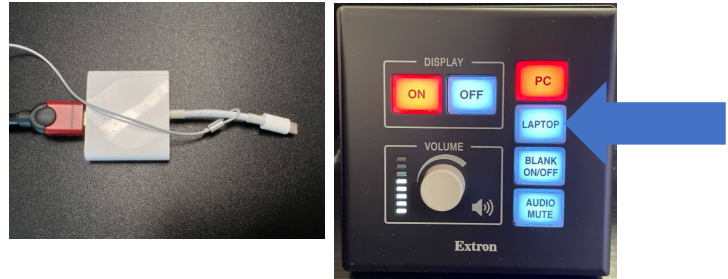

Give the system about 4 seconds to switch.

VOLUME:

- Use the KNOB to adjust volume of PC or Laptop sound
- Webcam: Ceiling mounted
- Audio: Flat Mic on the podium (Both are SET in ZOOM already as defaults on the podium PC)



TURN THE SYSTEM OFF:

- Press the "OFF" button.

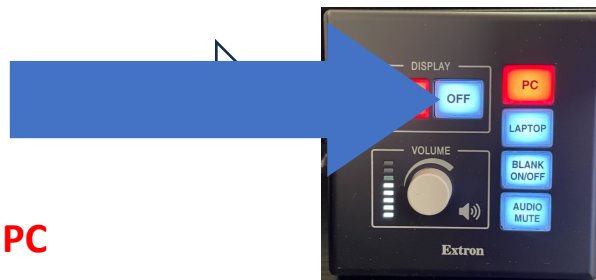

PLEASE DO NOT SHUT DOWN THE PC

PLEASE DO NOT WRITE ON THE GRAY PROJECTOR SCREEN

PLEASE DO NOT MOVE THE PODIUM

Luskin IT Support (310.206.6767)
Email: ITSUPPORT@LUSKIN.UCLA.EDU

4320 Classroom Quick Guide